

GA2-STI

GA2-S





Configuration

Easier than ever.



GA2-STI, GA2-S

The device designed to assist pedestrian access control at guarded passage ways inside buildings and vehicles.

Examples of use:

- points of ticket control and access control for passenger traffic in busses, buildings,
- airports/seaports,
- passages for authorised personnel, directing passenger traffic,
- points of access control in secured buildings (e.g. state offices such as border crossing points, other services),
- points of ticket control and fees at museums, theatres, cinemas, exhibitions, fair areas, show facilities, paid toilets, points of ticket control at sports facilities, e.g. swimming pools, stadiums, other sports and show facilities,
- access and time attendance control points in working places, e.g. offices, dedicated areas in factories.





RENDER Z FUNKCJA

Save money and space in Your building

Mounted to the wall

Verified in hard conditions.



DESCRIPTION OF DEVICE

TYPE OF

GA2-ST1

GA2-S



FINISHING

Finishing of housing and support stand



Stainless steel - INOX AISI 304



RAL 9006



RAL 9005



RAL 5010



RAL 6002



RAL 9003

Standard colour/standard finishing

Non-standard colour/non-standard finishing



FUNCTIONS

- The highest priority input for clearing/opening the passage section

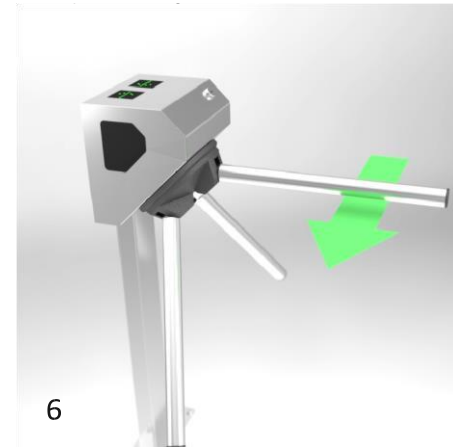
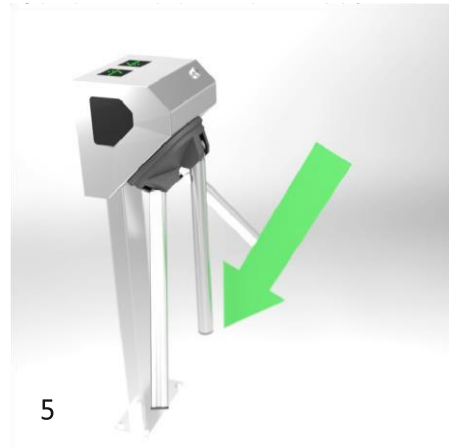
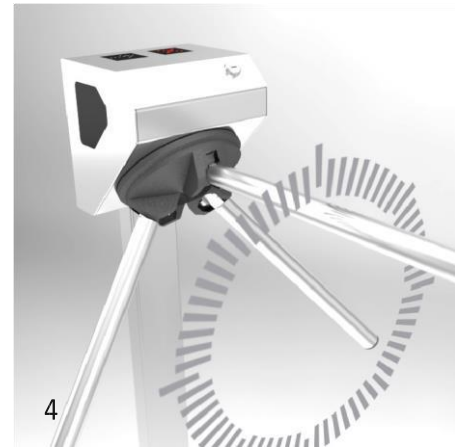
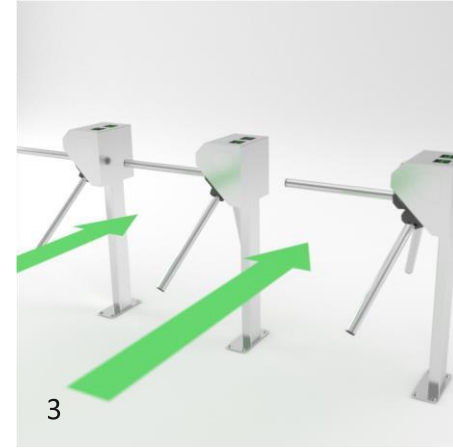
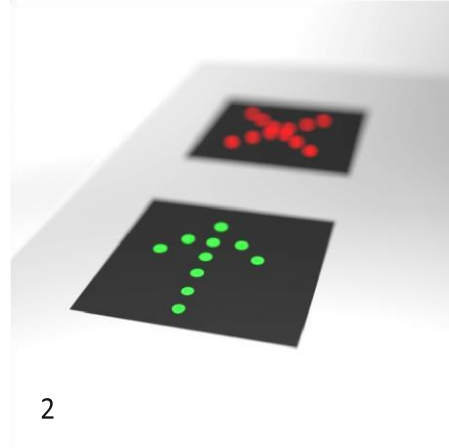

Automatic arm drop function (function in the model)

mechanical arm rotation aid which helps in easy and

1. EASY SETTING

Configuration of operation modes and function is easy with the use of a control panel with a display and an encoder.

easy with the use of a control panel with a display

equipment is not included with the device.

4. PRECISE MEASUREMENT SYSTEM

The device is equipped with an electronic rotor position measurement system that allows the control system to control the work of the lock system.

- Feedback signal output (0V signal) informing about a passage of a person based on an authorising signal,
- A higher priority input for excluding the section from operation (e.g. from the building management system),

(e.g. from the firefighting system),

TECHNICAL PARAMETERS

- Functions: remembering steering signals during the working cycle, MECHANISMS sound signalling, diode signalling, automatic calibration
- Mechanisms are designed for continuous operation. Mechanisms allow 1200 cycles / hour.

MECHANISM [GA2]

Mechanism equipped with:

- mechanical arm support,
- blockade system for the arms,
- precise measurement system for arms position,- automatic unlocking in case of electrical power failure.

PARAMETERS

Power supply voltage:	~24 V AC
Maximum power consumption:	75 VA
Minimum power consumption:	2.2 A
Steering signal:	max. 0.5 sec
Feedback signal:	0V
Operation temperature:	-20° to +50° C [-4° to 122°F]
Storage temperature:	-30° do +60° C [-22° to 140°F]
Maximum humidity:	10-80%
Operation environment:	inside buildings
IP protection rate:	IP 43
Net weight - MODEL „S“	~60kg [132 lb]
Net weight - MODEL „STI“	~60kg [132 lb]

DEFINITIONS OF DEVICES - WITHOUT DROP ARM FUNCTION

DEFINITIONS	Model	Housing finishing	OF DEVICES - WITH
	GA2 - STI	INOX/RAL . . .	
DROP ARM	GA2 - S	INOX/RAL . . .	FUNCTION

Model	Housing finishing
GA2 - STI - DA	INOX/RAL . . .
GA2 - S - DA	INOX/RAL . . .

Samples:

*GA2 - STI - RAL5010 - a GA2-STI turnstile finished with steel color RAL5010.

*GA2- S - DA - INOX - a GA2-S turnstile with arm drop function finished with steel in grade AISI 304.

OPTIONAL EQUIPMENT*

Name	Description
Power supply	Power supply 230/24V
Control panel	Control panel for manual traffic control

ELECTRONIC SYSTEM

- Steering

input (0V signal) for each traffic direction individually * Optional

DIMENSIONS GA2-STI

DIMENSIONS GA2-S

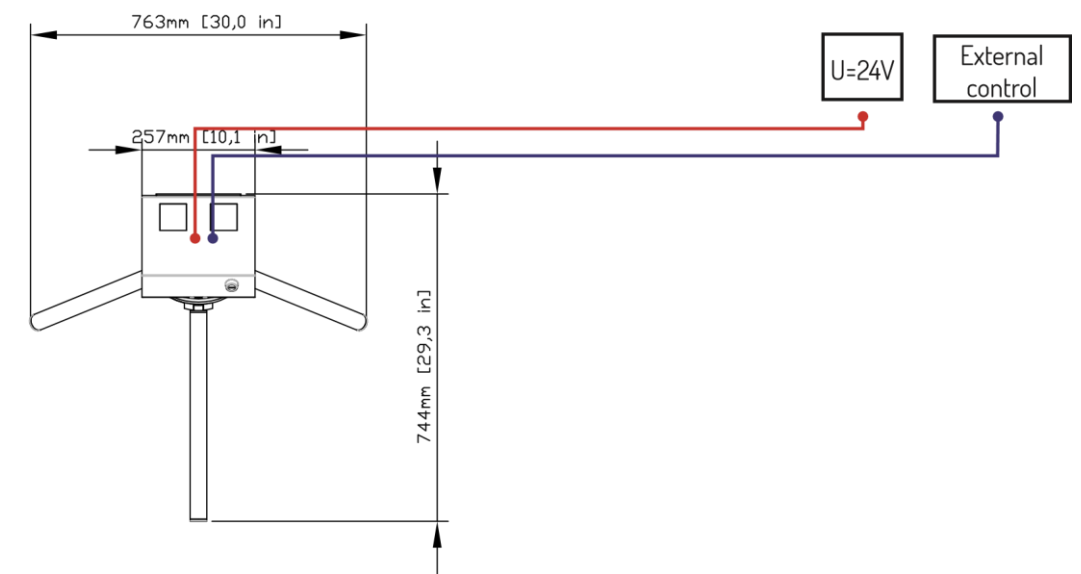
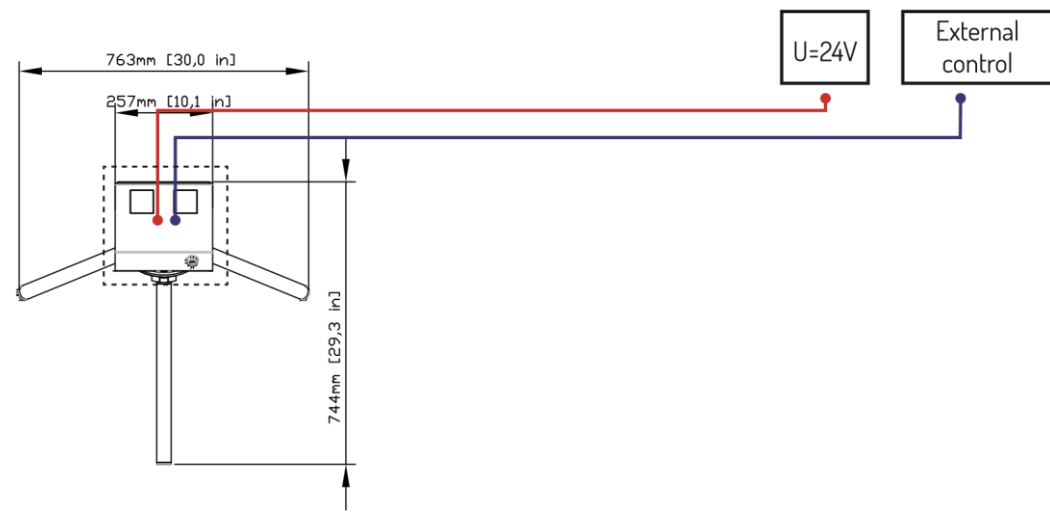
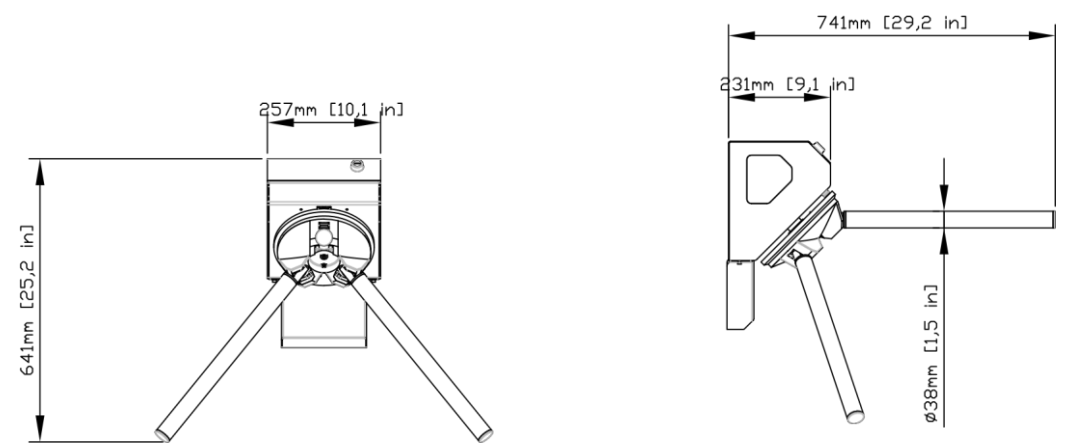
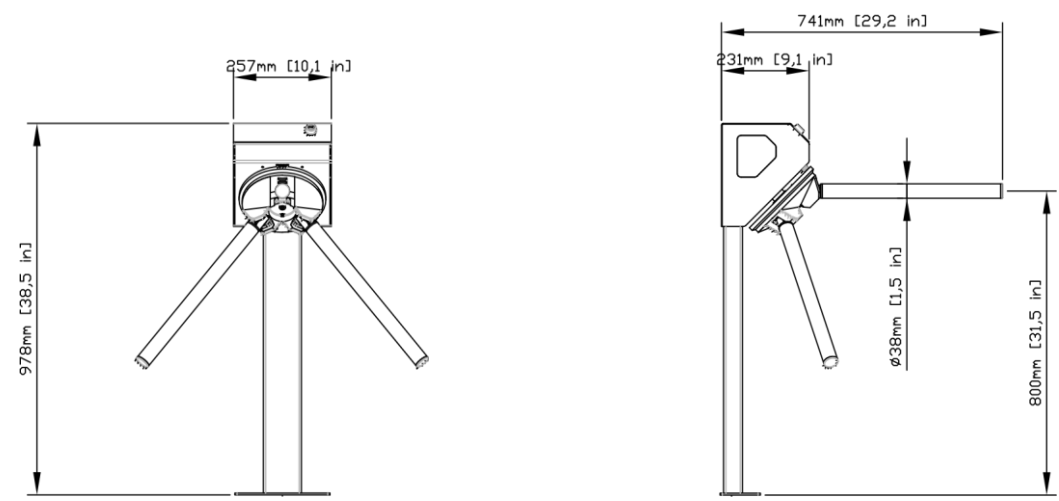

KEY:

- Steering from the outside - an S/UTP strand
- 24 V supply - 0MY wire 3x1.5mm
- Foundation

KEY:

- Steering from the outside - an S/UTP strand
- 24 V supply - 0MY wire 3x1.5mm
- Foundation

Kontakt: KLISING d.o.o.

**e-mail: info@edge-
group.info**

